

ACP-200F

Features

- ▶ Load Capacity
441 lbs/ea | 882 lbs w/4
- ▶ Swivel Plate Top
- ▶ Unit Weight 1.23 lbs



**Available in black*

Dimensions

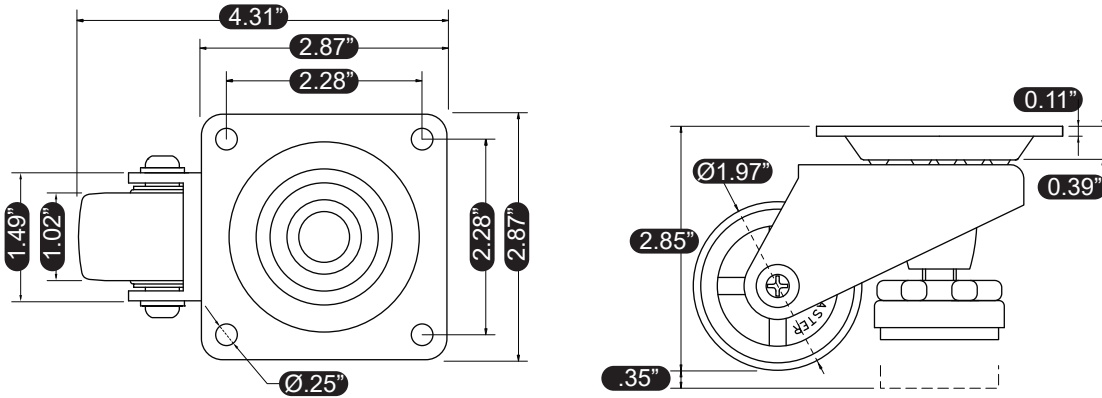

Materials & Treatments

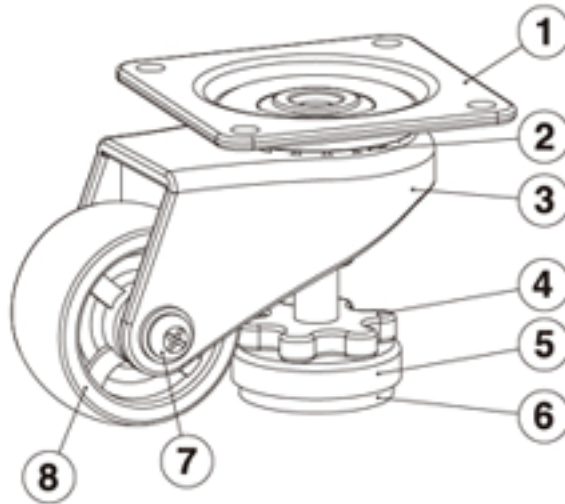

Parts	Materials	Treatments
1	Top Plate	SPC & S45C
2	Ball	STB2
3	Frame	SPC
4	Leveler	Swrch 10A
		Zn Galvanized

Parts	Materials	Treatments
5	Cup	SPC
6	Foot	NBR & Urethane
7	Pin	Swrch 10A
8	Wheel	PA6
		Zn Galvanized
		Black