

APLC-200F

Features

- ▶ Load Capacity
441 lbs/ea | 882 lbs w/4
- ▶ Swivel Top
- ▶ Unit Weight 1.28 lbs

Dimensions

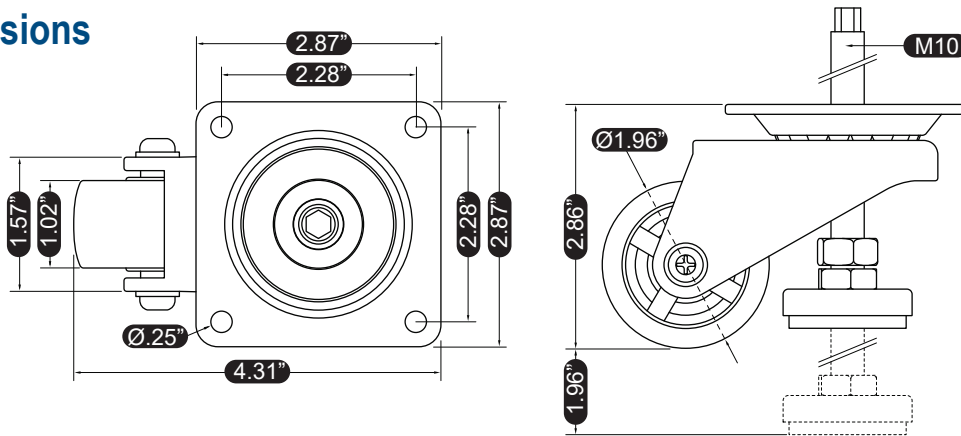

Materials & Treatments

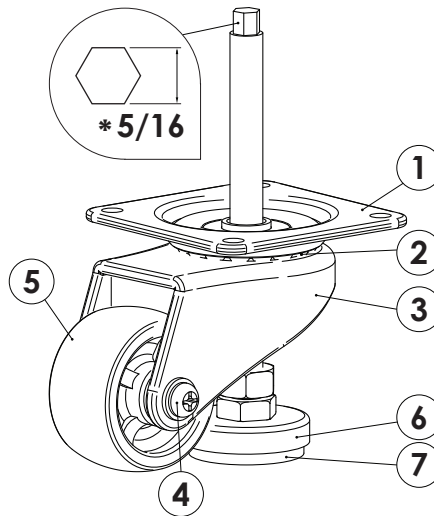

*Wrench Size in SAE

Parts	Materials	Treatments
1 Top Plate	SPC	Zn Galvanized
2 Ball	STB2	Ni-Cr
3 Frame	SPC	Zn Galvanized
4 Pin	Swrch 10A	Zn Galvanized

Parts	Materials	Treatments
5 Wheel	PA6	Black
6 Cup	SPC	Zn Galvanized
7 Foot	NBR	Black